





Anlage 4B-39

Karte 1 von 10



0 100 200 300 Meter

-  Grundstücksgrenze
-  Grundwasserkörper GK 100097 Grazer Feld
-  Grundwasserkörper GK 100098 Leibnitzer Feld
-  Grundwasserkörper GK 100102 Unteres Murtal

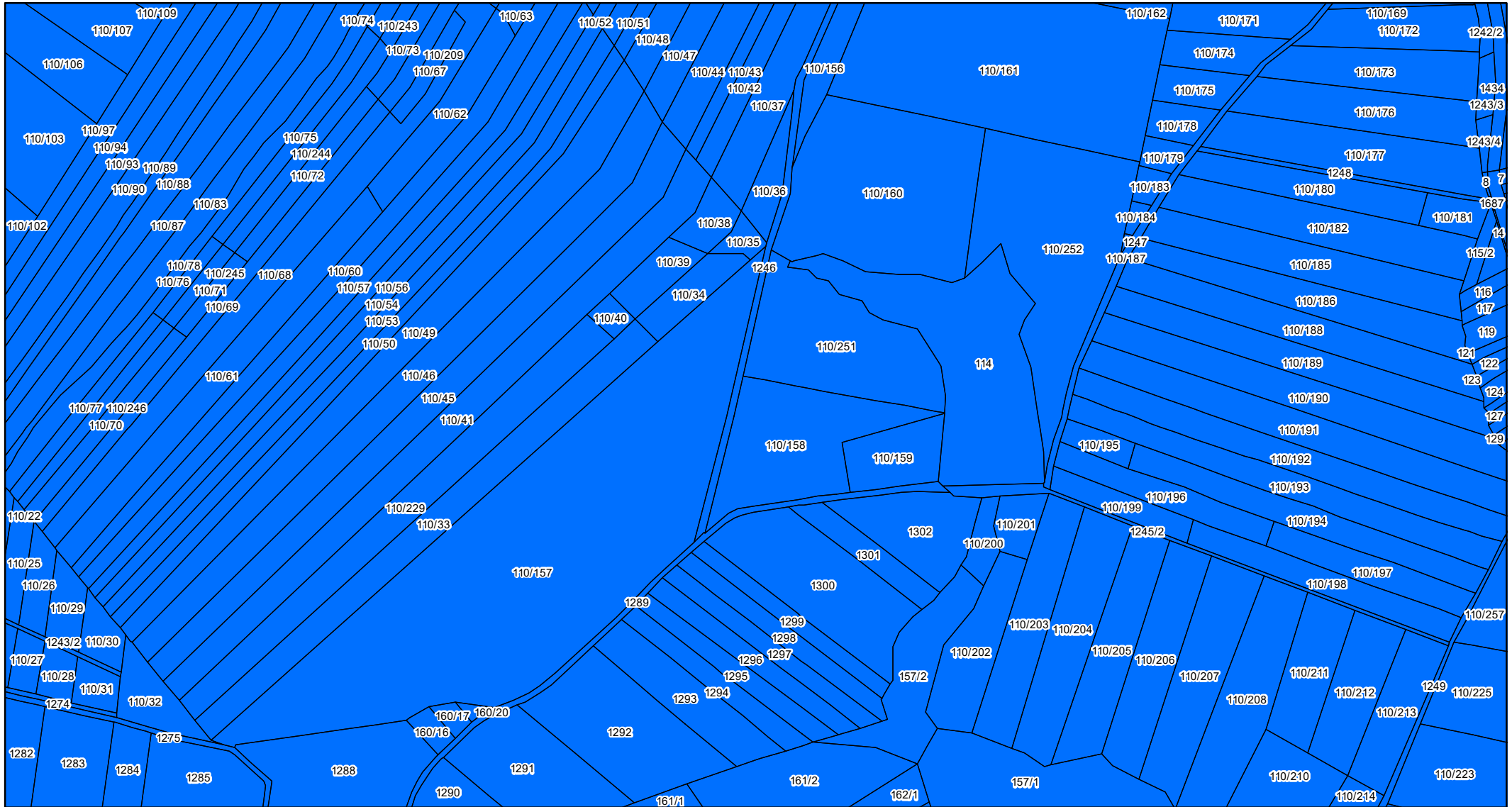

Anlage 4B-39



0 100 200 300 Meter

Datenquelle: GIS-Steiermark DKM: © BEV 2022
Erstellung: Amt der Steiermärkischen Landesregierung
April 2023



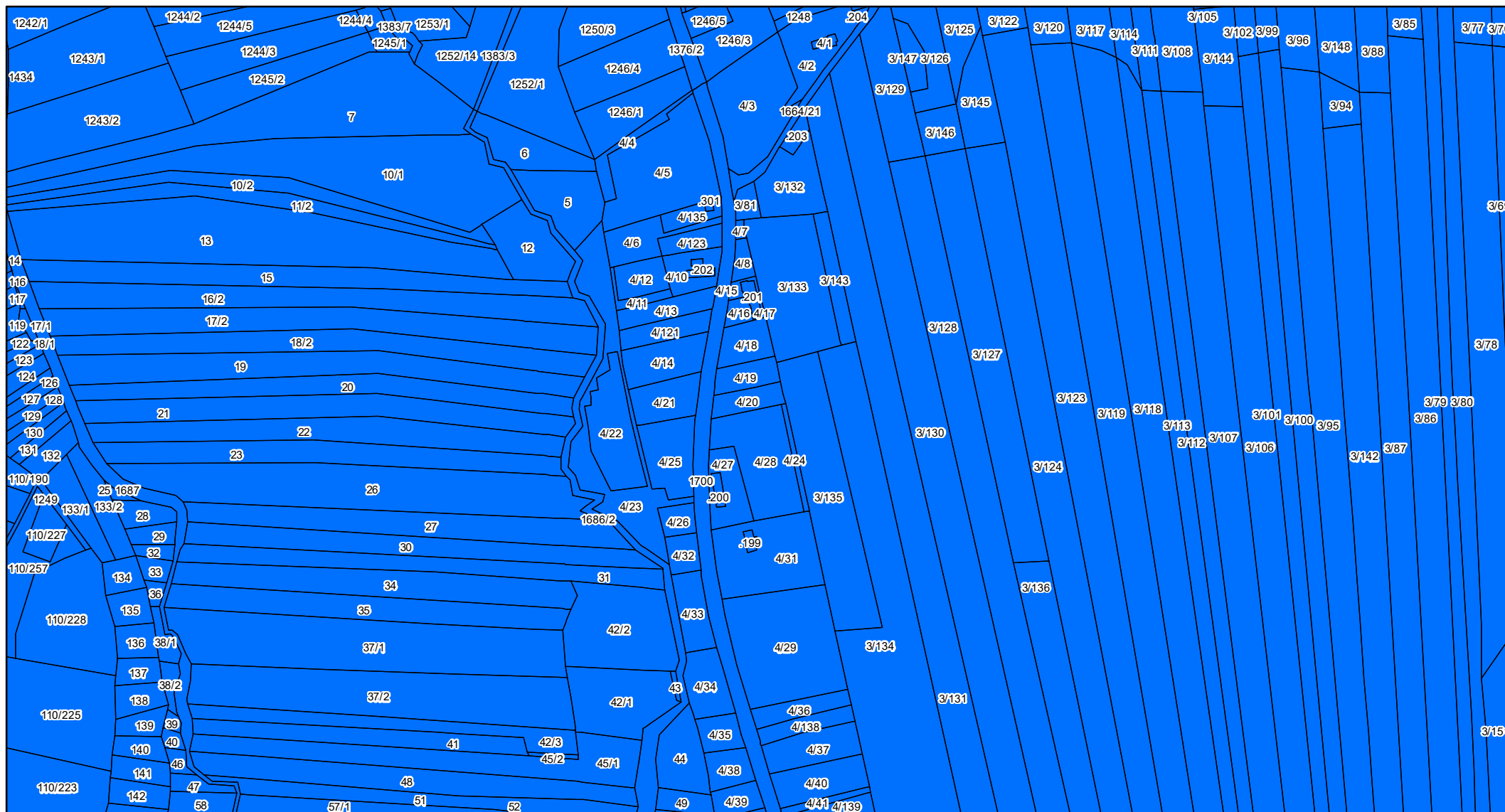

- Grundstücksgrenze
- Grundwasserkörper GK 100097 Grazer Feld
- Grundwasserkörper GK 100098 Leibnitzer Feld
- Grundwasserkörper GK 100102 Unteres Murtal





0 100 200 300 Meter

Datenquelle: GIS-Steiermark DKM: © BEV 2022
Erstellung: Amt der Steiermärkischen Landesregierung
April 2023

-  Grundstücksgrenze
-  Grundwasserkörper GK 100097 Grazer Feld
-  Grundwasserkörper GK 100098 Leibnitzer Feld
-  Grundwasserkörper GK 100102 Unteres Murtal

Anlage 4B-39

Karte 3 von 10

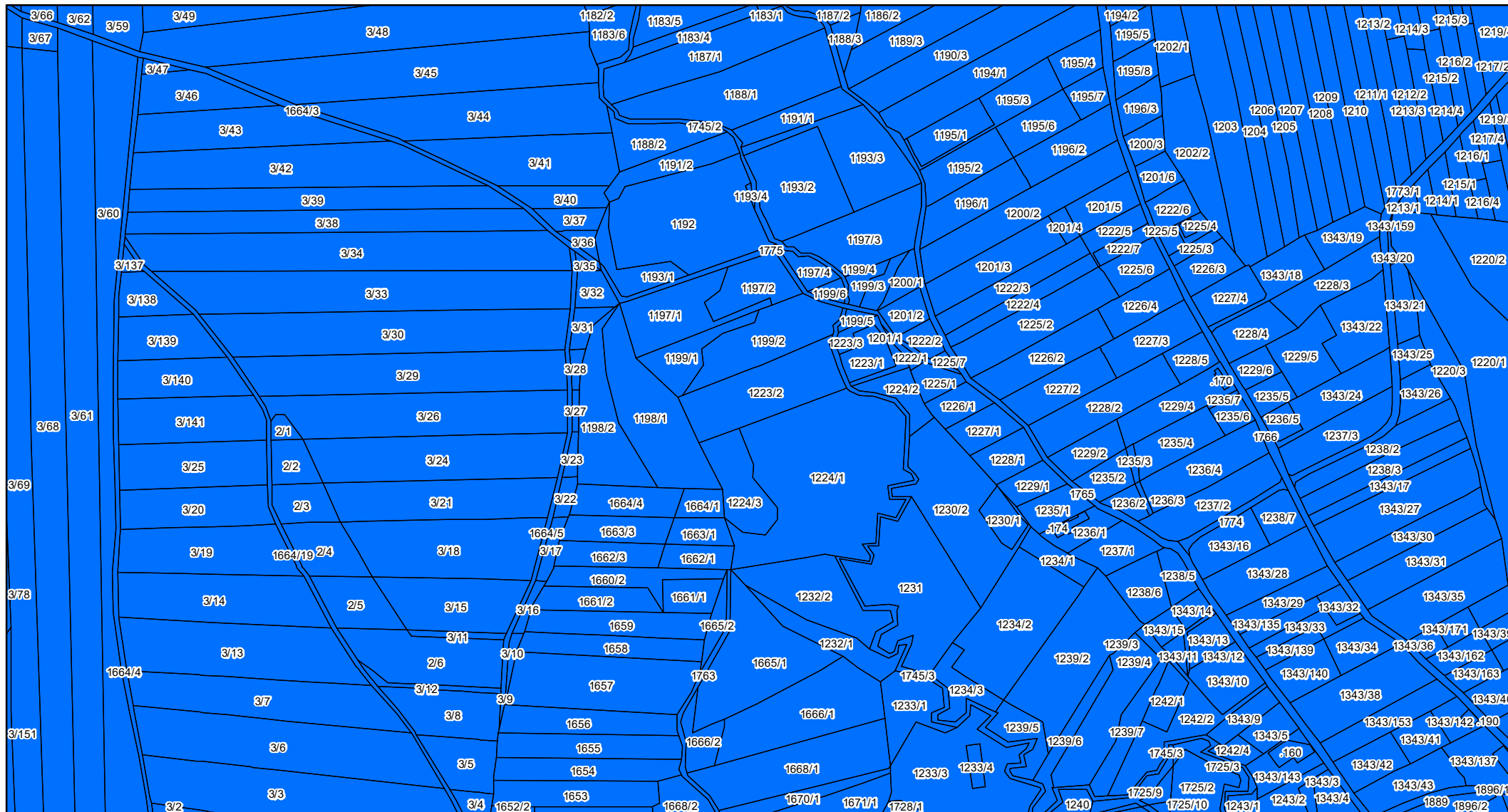

Anlage 4B-39

Karte 4 von 10

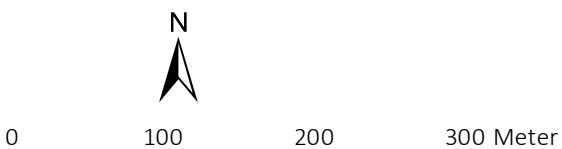

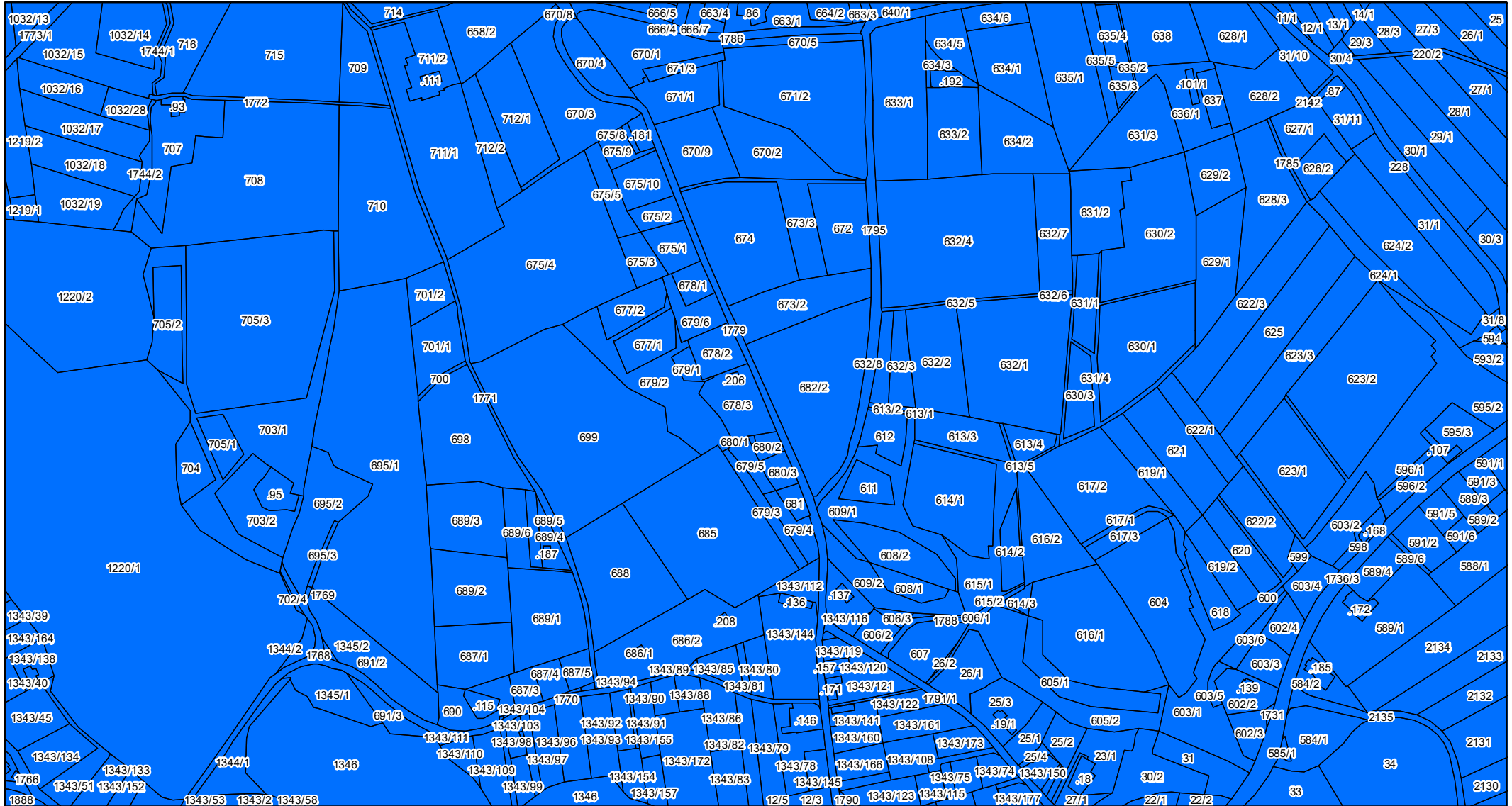

Datenquelle: GIS-Steiermark DKM: © BEV 2022
 Erstellung: Amt der Steiermärkischen Landesregierung
 April 2023

- Grundstücksgrenze
- Grundwasserkörper GK 100097 Grazer Feld
- Grundwasserkörper GK 100098 Leibnitzer Feld
- Grundwasserkörper GK 100102 Unteres Murtal



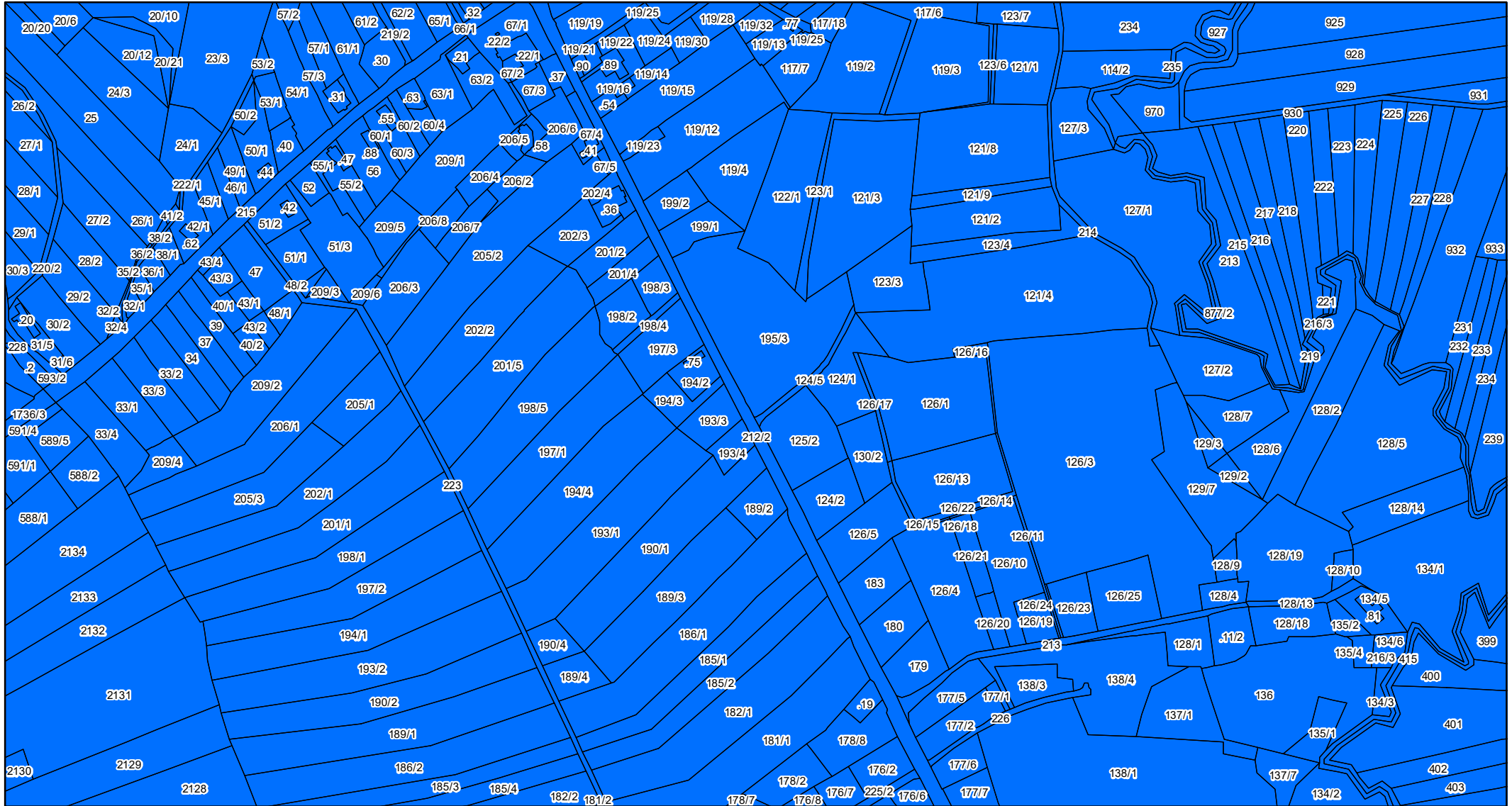

0 100 200 300 Meter

-  Grundstücksgrenze
-  Grundwasserkörper GK 100097 Grazer Feld
-  Grundwasserkörper GK 100098 Leibnitzer Feld
-  Grundwasserkörper GK 100102 Unteres Murtal



0 100 200 300 Meter



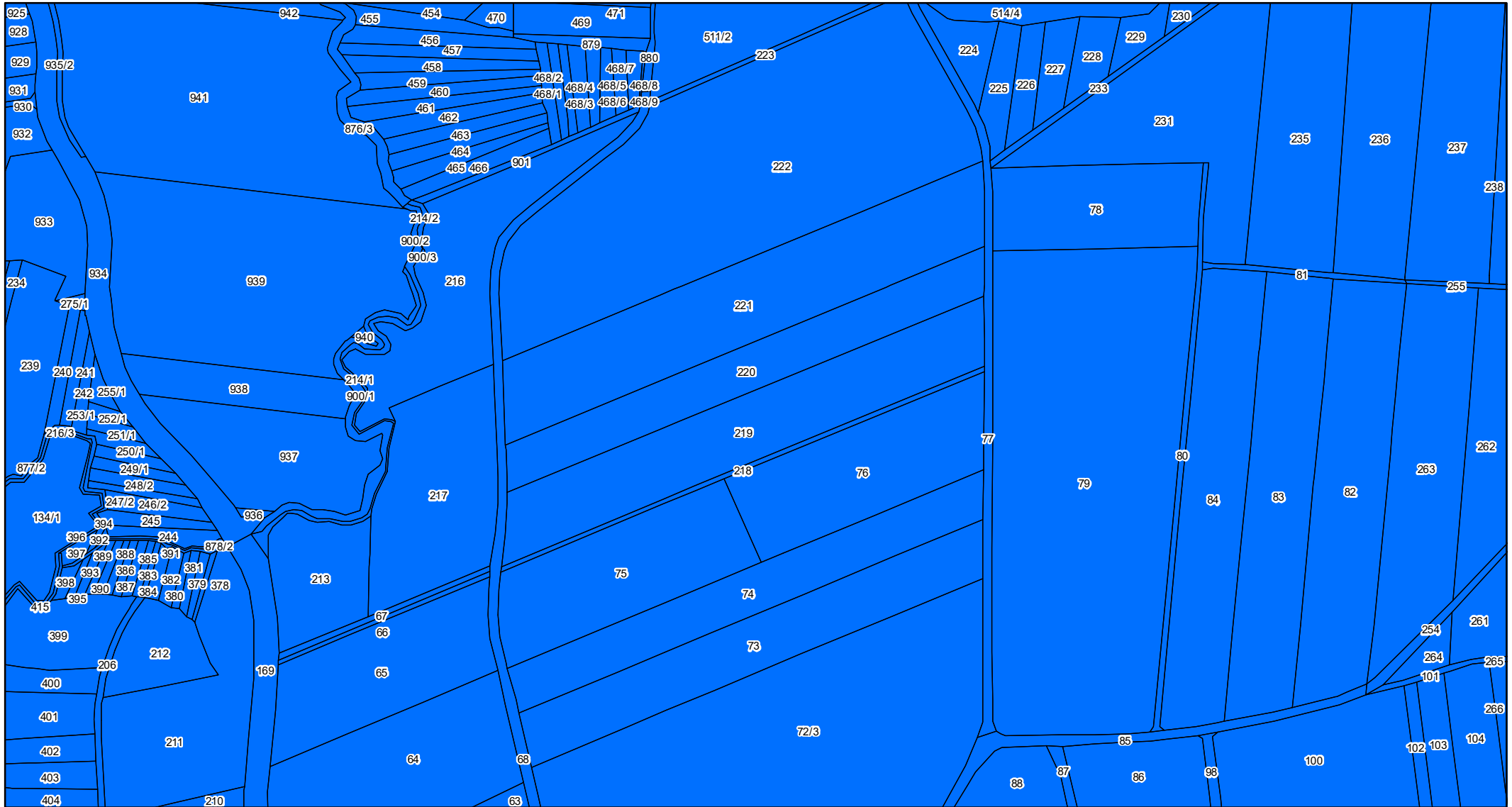

Datenquelle: GIS-Steiermark DKM: © BEV 2022
Erstellung: Amt der Steiermärkischen Landesregierung
April 2023

-  Grundstücksgrenze
-  Grundwasserkörper GK 100097 Grazer Feld
-  Grundwasserkörper GK 100098 Leibnitzer Feld
-  Grundwasserkörper GK 100102 Unteres Murtal



0 100 200 300 Meter

Datenquelle: GIS-Steiermark DKM: © BEV 2022
 Erstellung: Amt der Steiermärkischen Landesregierung
 April 2023

-  Grundstücksgrenze
-  Grundwasserkörper GK 100097 Grazer Feld
-  Grundwasserkörper GK 100098 Leibnitzer Feld
-  Grundwasserkörper GK 100102 Unteres Murtal



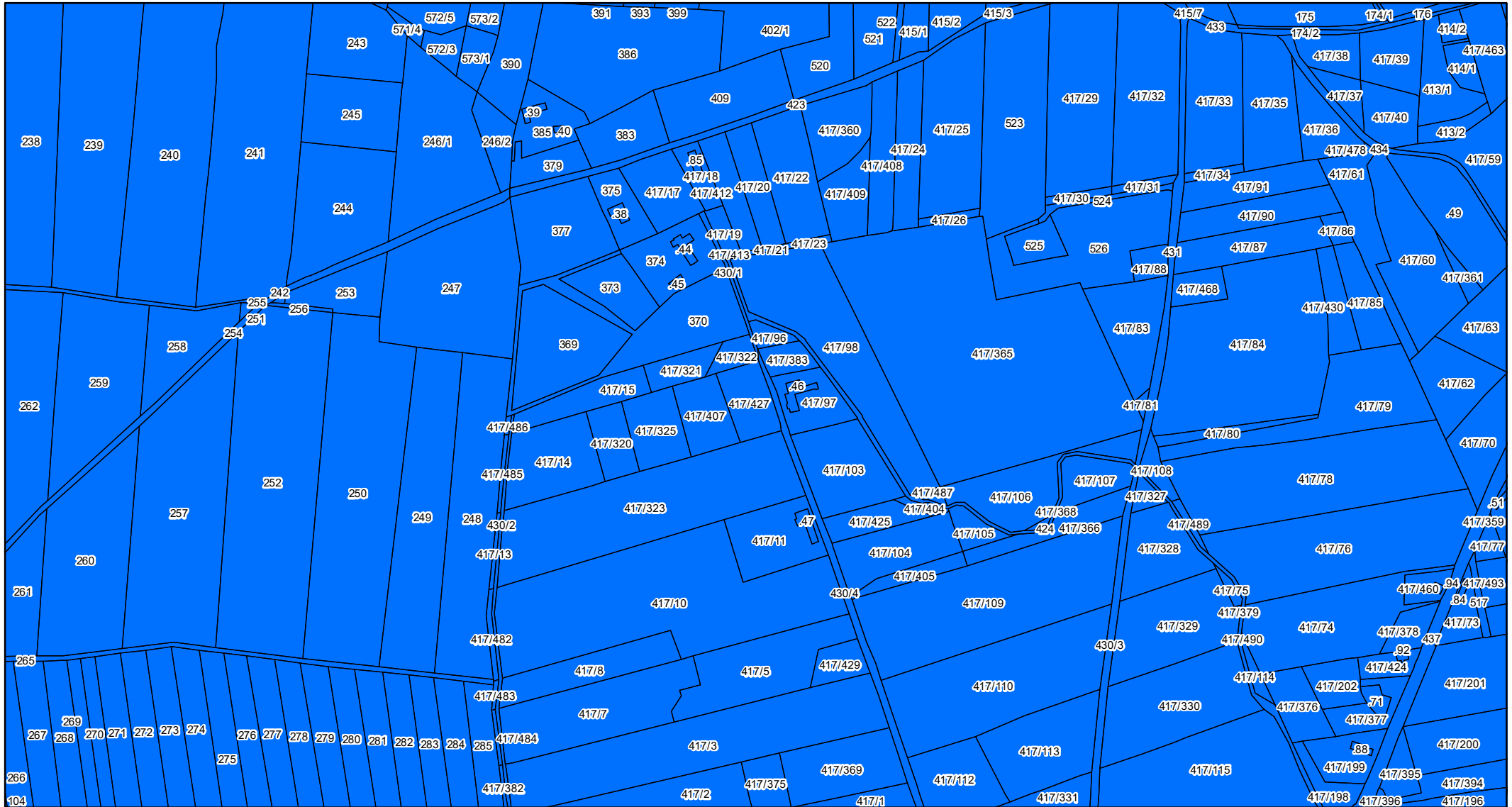

Anlage 4B-39

Karte 7 von 10



0 100 200 300 Meter

Datenquelle: GIS-Steiermark DKM: © BEV 2022
Erstellung: Amt der Steiermärkischen Landesregierung
April 2023

-  Grundstücksgrenze
-  Grundwasserkörper GK 100097 Grazer Feld
-  Grundwasserkörper GK 100098 Leibnitzer Feld
-  Grundwasserkörper GK 100102 Unteres Murtal

Anlage 4B-39

Karte 8 von 10

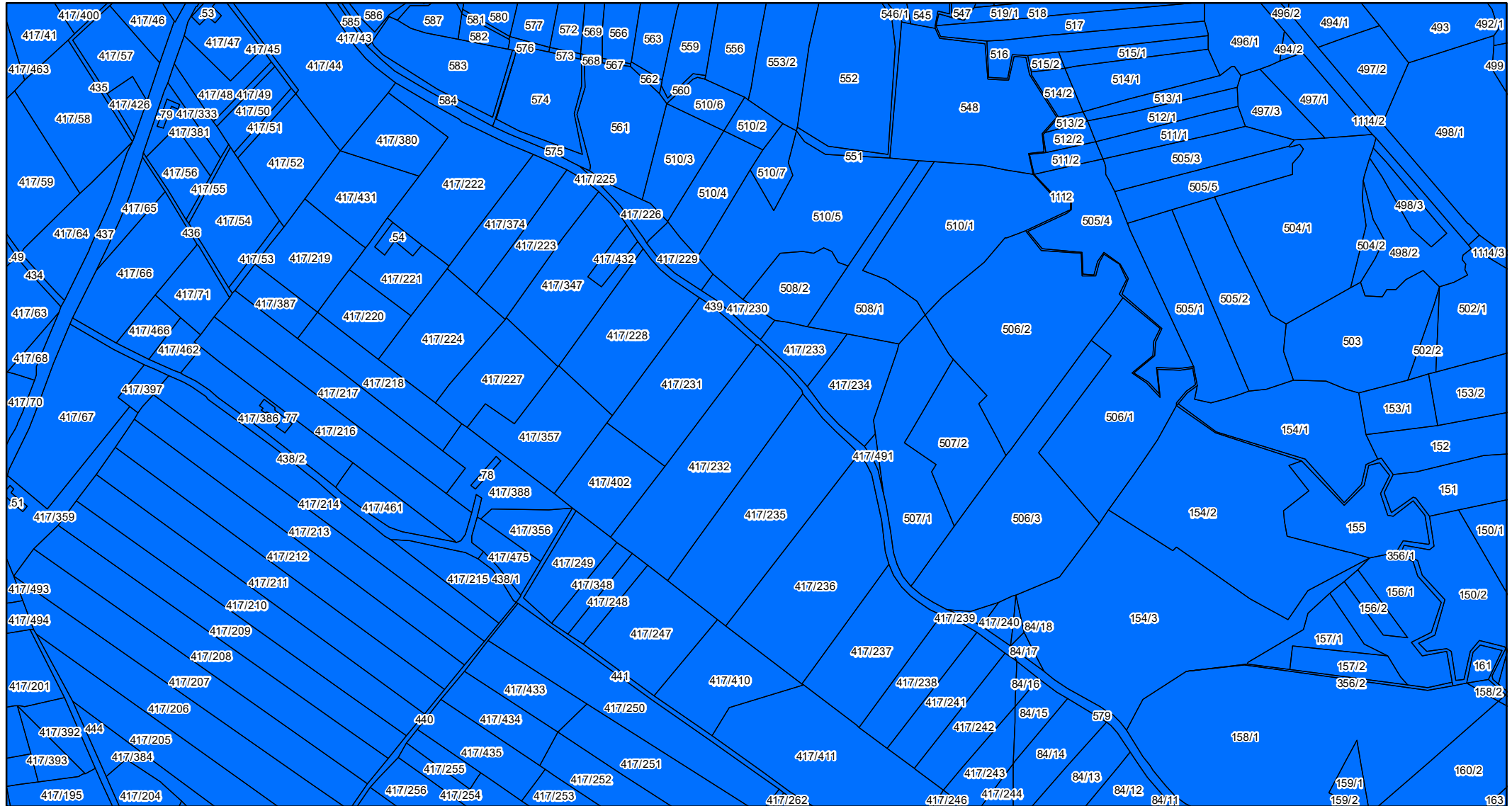

0 100 200 300 Meter

Datenquelle: GIS-Steiermark DKM: © BEV 2022
Erstellung: Amt der Steiermärkischen Landesregierung
April 2023

- Grundstücksgrenze
- Grundwasserkörper GK 100097 Grazer Feld
- Grundwasserkörper GK 100098 Leibnitzer Feld
- Grundwasserkörper GK 100102 Unteres Murtal

Anlage 4B-39



Karte 9 von 10

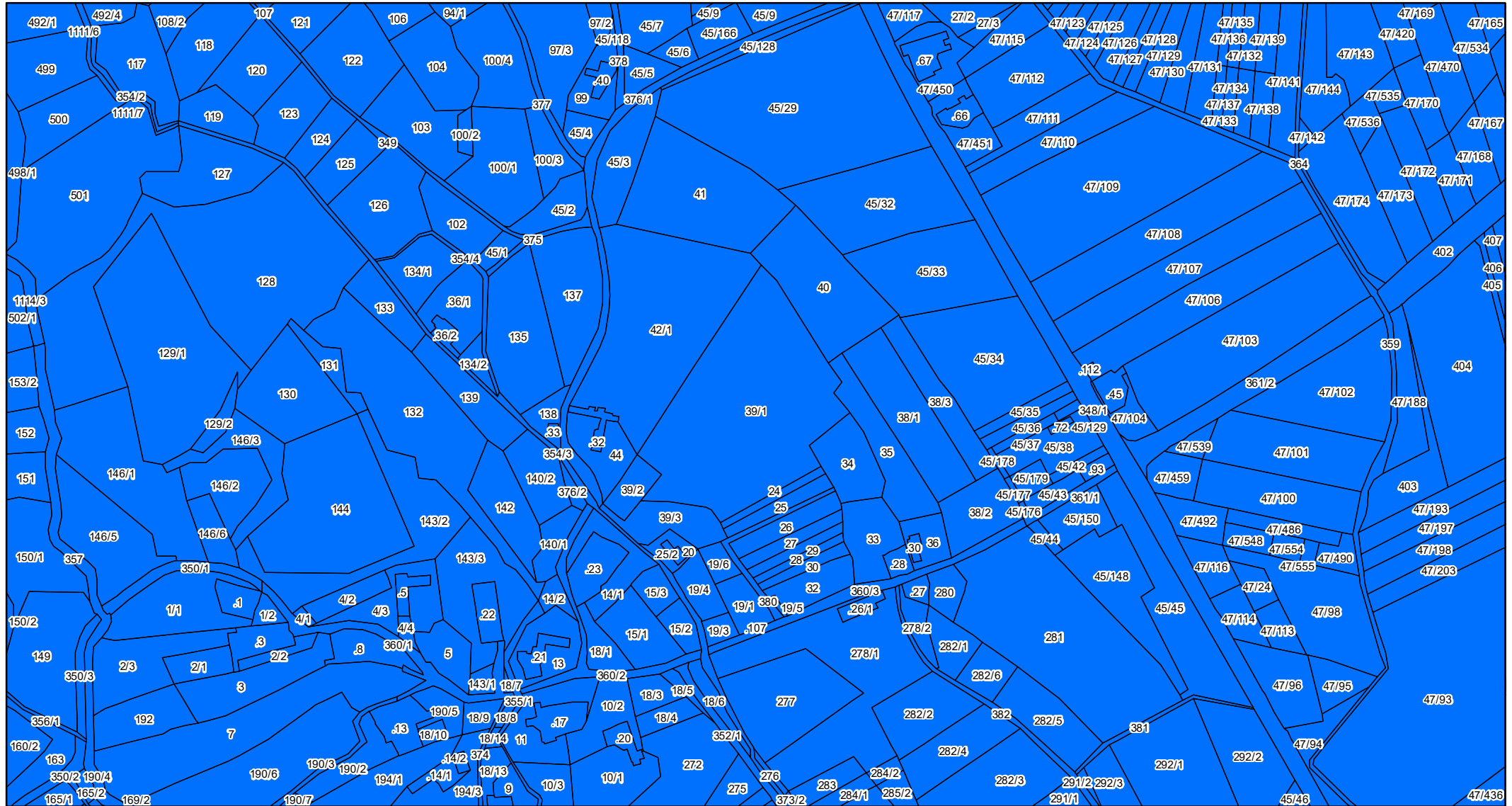



0 100 200 300 Meter

Datenquelle: GIS-Steiermark DKM: © BEV 2022
Erstellung: Amt der Steiermärkischen Landesregierung
April 2023

-  Grundstücksgrenze
-  Grundwasserkörper GK 100097 Grazer Feld
-  Grundwasserkörper GK 100098 Leibnitzer Feld
-  Grundwasserkörper GK 100102 Unteres Murtal

Anlage 4B-39

Karte 10 von 10